



PCM

£1,100



****AVAILABLE END OF FEBRUARY - UNFURNISHED. INTERNAL PHOTOS ARE OF SHOW FLAT****

A selection of one and two bedroom executive apartments in a brand new development of only six flats, situated in a prestigious private cul-de-sac located to the West side of High Wycombe, and within easy reach of the town centre. This spacious top floor one bedroom apartment offers well-proportioned accommodation of 621 sq ft, comprising; Entrance hallway; modern fitted kitchen; bright and airy living room; bedroom with patio door opening on to large balcony; family bathroom. The property also benefits from: Entry system, off-street allocated parking and bike store.

COUNCIL TAX BAND: TBC BY LOCAL AUTHORITY

HOLDING FEE: £253.85

DEPOSIT REQUIRED: £1269.23

LENGTH OF TENANCY: 12 MONTHS

- 621 SQ FT
- FITTED KITCHEN
- BIKE STORE
- ALLOCATED PARKING
- LARGE HALLWAY
- SPACIOUS BALCONY
- ONE BEDROOM
- BRAND NEW
- TOP FLOOR
- CUL-DE-SAC



53 Templeside Gardens, High Wycombe, HP12 3FQ

Estate Agents ~ Lettings Agents ~ Valuers ~ Independent Mortgage Advisors

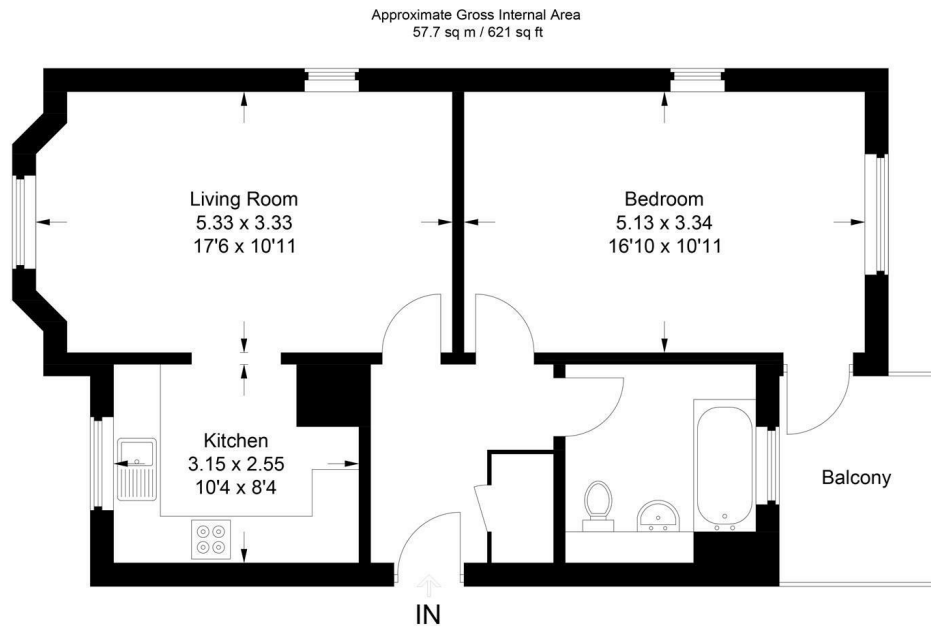

This plan is for layout guidance only. Not drawn to scale unless stated. Windows and door openings are approximate. Whilst every care is taken in the preparation of this plan, please check all dimensions, shapes and compass bearings before making any decisions reliant upon them.
© CJ Property Marketing Ltd Produced for Hurst

Hurst
Estate Agents